



ZT4201E-L

EGO's Z6 Zero-turn Ride-on Mower is the world's first platform-compatible ZTR, powered by any combination of EGO 56V ARC Lithium™ batteries. Included in this kit is the industries fastest multi-port charger which can charge up to 6 batteries at the same time.

Product Details

| | |
|------------|----------------------------------|
| Model Name | Z6 ZERO-TURN RIDE-ON MOWER (KIT) |
|------------|----------------------------------|

Marketing Information

| | |
|------------|----------------------------------|
| Model Name | Z6 ZERO-TURN RIDE-ON MOWER (KIT) |
|------------|----------------------------------|

| | |
|------------------|--|
| Category Bullets | <p>The Z6 handles tight corners easily with on-the-spot turning. Equipped with the latest in digital technology and cruise control, the Z6 takes maneuverability to the next level with 3 customisable driving modes: Control, Standard and Sport.</p> |
|------------------|--|

| | |
|-----------------------|--|
| PDP Short Description | <p>EGO's Z6 Zero-turn Ride-on Mower is the world's first platform-compatible ZTR, powered by any combination of EGO 56V ARC Lithium™ batteries. Included in this kit is the industries fastest multi-port charger which can charge up to 6 batteries at the same time.</p> |
|-----------------------|--|

| | |
|------------------|--|
| Long Description | <p>Delivering the equivalent power of a 22 horsepower petrol engine, with none of the emissions, the Z6 covers up to 2.5 acres on a single charge with six 12Ah batteries. You can tailor the combination of batteries exactly to match the size of your lawn, and to how you prefer to cut your grass – unlike any other battery-powered ZTR on the market.</p> <p>The industry's fastest charger fully charges 4 x 10Ah in just 2 hours, 4x faster than any of the competition, while the four independent brushless motors deliver the power and performance of petrol to get the job done. It reaches a top speed of 8MPH and will cover up to 2.5 acres on a single charge with six 12Ah batteries.</p> <p>The LCD screen is intuitive, allowing you to control the mower's speed, mode, and cutting speed, plus you can see exactly how much charge you have left.</p> <p>Choose between three driving modes. Standard mode which you can use for everyday tasks, Control which will protect your turf and is perfect for new zero-turn users, or Sport which is great for precision cuts around sharp turns. It also has Bluetooth connectivity so you can enable a remote key from your mobile, take full control of your mowing experience, monitor your battery, and download firmware updates to receive the latest features.</p> <p>There are 10 cutting height settings which range between 2.5 – 10cm. These are easily adjustable with one hand by using the ergonomic handles. You've got the choice to mulch, bag or side-discharge whilst mowing, so not only can you dial in to the perfect cut, but you can also do what you require with the clippings. (Bagging kit sold separately).</p> <p>The features don't end there – 32 high-intensity LED lights illuminate your view when conditions get a little more challenging, you can stay hydrated whilst working with a helpful drink holder which is</p> |
|------------------|--|

designed for large tumblers, plus a storage compartment including a slot for your mobile phone – which you can also charge whilst driving via the useful USB port.

SUPPLIED COMPLETE AS: Inc. 1600W charger and mulching plug (CHV1600E, AMP4200)

Batteries not included. Minimum 15Ah required to function

| | |
|---------------------------|--|
| Packaging Contains | 1x Z6 Zero-Turn Ride-On Mower [ZT4200E-L] 1x 1600W Charger [CHV1600E] 1x Ride-On Mower Mulching Plug [AMP4200] |
|---------------------------|--|

Technical Specifications

| | |
|------------------------------|-----------------------------------|
| EAN/UPC Local | 6924969118221 |
| Model Number (Item) | {Order No. CSO} |
| Order No. | ZT4201E-L |
| Plug Type | Type F 2 Pin DE CEE 7/7 (Schuko) |
| Battery Port | Multi Port |
| Brushless Motor | Brushless |
| Control | Lap Bar ZTR |
| Cutting Options | Side discharge, Bagging, Mulching |
| Number Of Blade | 2 |
| Deck Construction | Stamped |
| Cut Height Number | 10 |
| Light | Yes |
| Seat Suspension | Yes |
| LCD Display | 5 in |
| Drive Mode Selection | 4 settings + Travel |
| Drive Speed Selection | 4 settings + Turbo |
| Blade Speed Selection | 4 settings + Turbo |
| IP Class | IPX4 |
| Cutting Width (cm) | 107 |
| USB Charging Port | Yes |
| LED Headlights | Yes |

| | |
|-----------------------|----------------------------------|
| Floor Mat | Si |
| Status Indicator | Yes |
| Armrest | Yes |
| Cup Holder | Yes |
| Glove Box | Yes |
| Phone Holder | Yes |
| Tow Hitch | Yes |
| Beeper | Yes |
| Parking Break | Yes |
| Autohold | Yes |
| Connectivity | Yes |
| Grass Bagger | Yes |
| Mulching Plug | Yes |
| Forward Speed (km/h) | 11.2 (12.8 km/h in travel model) |
| Reverse Speed (km/h) | 5.6 |
| Frame (cm) | 5.08*3.04 Tubular frame |
| Cut Height (cm) | 3.81~11.43 |
| Front Wheel Size (cm) | 27.94 X10.16 |
| Rear Wheel Size (cm) | 45.72X21.59 |
| Seat (cm) | 45.72(high back padded seat) |
| Tool Length (mm) | 1950.72 |
| Tool Width (mm) | 1127.76 |
| Tool Height (mm) | 975.36 |

Marketing Features

| | |
|----------|-----|
| Armrest | Yes |
| Autohold | Yes |

| | |
|-------------------|-----|
| Beeper | Yes |
| Connectivity | Yes |
| Cup Holder | Yes |
| Floor Mat | Si |
| Glove Box | Yes |
| Grass Bagger | Yes |
| Light | Yes |
| Mulching Plug | Yes |
| Parking Break | Yes |
| Phone Holder | Yes |
| Status Indicator | Yes |
| Tow Hitch | Yes |
| USB Charging Port | Yes |
| LED Headlights | Yes |

KEES VAN DER SPEK
TUIN EN PARKMACHINES * TER AAR

Packaging Details

| | | |
|----------------------------------|--------|-------------|
| Packaging Type | Item | Single Pack |
| Packaging Measurement Unit Type | Metric | Metric |
| Quantity | 1 | 1 |
| Weight | | 201.90 |
| Weight Unit | | Kilogram |
| Height (H) | | 83.3 |
| Height Unit | | Centimetre |
| Width (L) | | 213 |
| Width Unit | | Centimetre |
| Depth (W) | | 117 |
| Depth Unit | | Centimetre |
| Gross Weight Incl Packaging | | 206.22 |
| Gross Weight Incl Packaging Unit | | Kilogram |
| Item Number | | |

Accessories



EGO CHV1600E 1600W CHARGER



EGO AMP4200 RIDE-ON MOWER MULCHING PLUG



EGO ABK4200-A BAGGING KIT



EGO AB4200 53cm STANDARD BLADE



EGO AB4201 53cm BAGGING BLADE



EGO CRM001 RIDE-ON MOWER COVER

KEES VAN DER SPEK
TUIN EN PARKMACHINES * TER AAR

Main



ZT4201E-L_EGOEU_RIDE-ON-MOWER_MAIN_01.psd

Date created: 2023-10-19T07:11:35:000+0000

Date Changed: 2023-10-18T03:17:27:000+0000

Manual

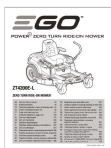

MNL_EGO_ZT4200E-L_EV01.31_211108.pdf

Date created: 2022-01-19T09:33:22:000+0000

Date Changed: 2022-01-19T09:33:22:000+0000

Explosion Diagrams

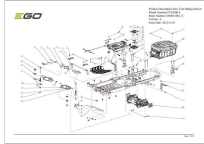

Explosion diagram_ZT4200E-L_A_22-0119.pdf

Date created: 2022-01-19T09:00:19:000+0000

Date Changed: 2022-01-19T09:00:19:000+0000

Compliance Reports



CE_EGO_ZT4200E-L_EV03.31_231218.pdf

Date created: 2024-02-02T02:44:03:000+0000

Date Changed: 2024-02-01T07:59:35:000+0000

CONFIDENTIAL.

Page 0CP / 0NP

KEES VAN DER SPEK
TUIN EN PARKMACHINES ★ TER AAR